

Shuttle Valves, Size 04 ... 10

Ball-type, Screw-in Design

Series WRVCG ... 50 l/min, 350 bar (500 bar)

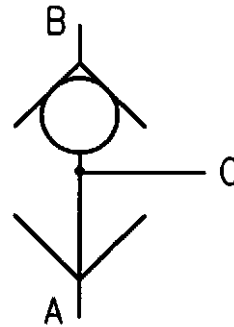

1 General

1.1 Product description

The WRVCG units are screw-in shuttle valves with mounting threads ranging from G 1/8" to G 1/2". For other thread forms, contact Bucher Hydraulics.

The valve shuts off whichever of the inlet ports A or B is at the lower pressure, with no leakage.

Port C is thus always connected to the higher pressure.

The units are ball-type valves with hardened seat and ball.

External O-rings and a backup ring seal the leakage path between the valve and cavity wall.

1.2 Advantages

- High pressure rating
- Virtually zero leakage
- Compact construction

2 Main characteristics

Designation	shuttle valve
Design	ball-type design
Mounting method	screw-in cartridge
Size	nominal 4...10 mm. See Table in section 5, Dimensions
Dimensions	see Table in section 5, Dimensions
Mounting attitude	unrestricted
No-flow direction	A → B, B → A (see symbol)
Operating pressure range	... 350 bar (for higher pressures, contact Bucher Hydraulics)
Flow rate, Q max.	... 50 l/min
Fluid	HL and HLP hydraulic oils to DIN 51524
Temperature range	-30°C... +80°C
Viscosity range	10... 500 mm ² /s (cSt)
Min. fluid cleanliness	18/14 to ISO 4406 / CETOP RP70H, 8...9 to NAS 1638

For applications outside these parameters, please contact Bucher Hydraulics.

3 Schematic section

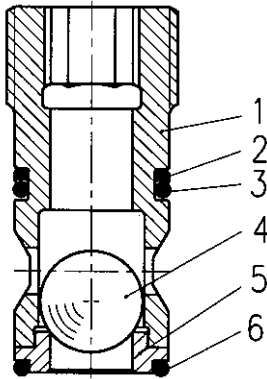

4 Components

Item	Qty.	Description
1	1	Valve body
2	1	Backup ring
3	1	O-ring
4	1	Ball
5	1	Valve seat
6	1	O-ring

5 Dimensions

5.1 Valve

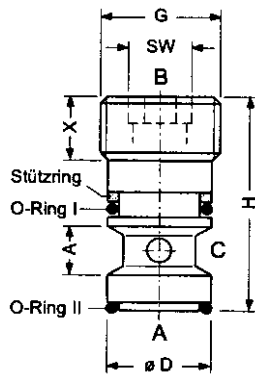

5.2 Cavity type WEG-01

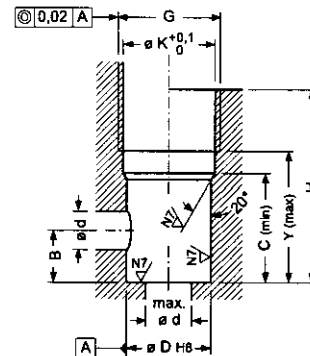

	Q Nom (l/min)	G	ØD	ØK	Ød	H	A	B	C	X	Y	SW (A/F)	Tightening torque (Nm)
WRVCG-04	8	G1/8"	8.5	8.70	4	24	4	5.7	14.30	7	14.5	5	5
WRVCG-06	15	G1/4"	11.5	11.75	6	30	6	8.0	15.85	10	18.0	6	10
WRVCG-08	30	G3/8"	15	15.25	8	36	8	10.0	21.85	10	24.0	8	20
WRVCG-10	50	G1/2"	18.5	19.00	10	45	10	14.0	25.70	12	29.0	10	40

	1 pc. O-ring I	1 pc. O-ring II	1 pc. Stützring (backup ring) PTFE
WRVCG-04	6.2 x 1.0	6.2 x 1.0	8.5 / 6.5 x 1.0
WRVCG-06	9.0 x 1.0	8.0 x 1.5	11.5 / 9.8 x 1.0
WRVCG-08	12.0 x 1.5	12.0 x 1.5	15.0 / 12.3 x 1.0
WRVCG-10	15.0 x 1.5	15.0 x 1.5	18.5 / 15.8 x 1.0

6 Performance graphs

measured with oil viscosity 33 mm²/s (cSt)

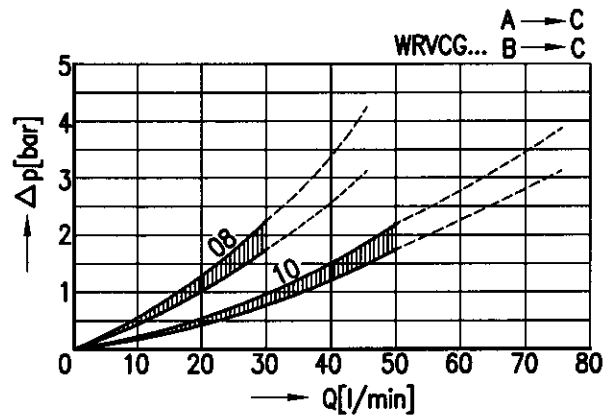
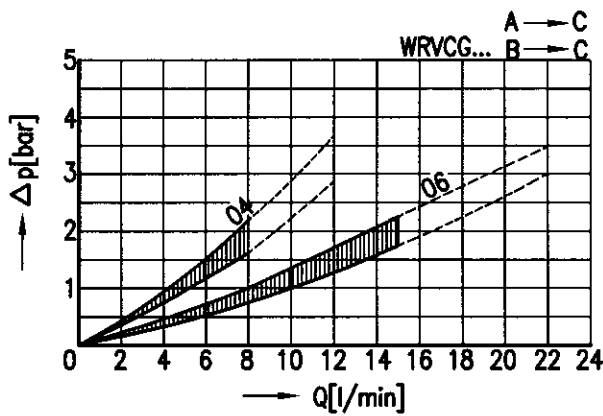

7 Ordering details

Model code key

Ex.

W	R	V	C	G
---	---	---	---	---

 -

--

 -

--

Shuttle valve, screw-in type

Ball design

Nominal size

04

06

08

10

O-rings

Nitrile

(blank)

Viton

V

Contact Bucher Hydraulics for further advice on:

- valves with metric or UNF threads
- special materials
- customised designs

8 Design and installation notes

The installation dimensions and tolerances must be maintained. The thread and the close-fitting cylindrical surface must be concentric.

We offer form tools for hire or sale.

Referring to the free-flow direction, nozzles and orifices must not be situ-

ated directly before the check valve (see Data Sheet 170-P-059000-E-00).

When fitting the valve, take particular care to ensure that:

- the valve is firmly seated on the sealing surface, but that
- valve components are not deformed by the use of excessive force

Recommendation: before installing the valve, fit the O-ring in the cavity.

Use the specified tightening torque when fitting the valve.

9 Application notes

The maximum operating pressure must not be exceeded and any pressure peaks must be taken into consideration.

The specified nominal flow rate must not be exceeded.

In applications such as accumulator circuits, where sudden pressure can be applied to the valve in the free-flow direction, ensure that the specified flow ratings are not exceeded.

Buyers bear the sole responsibility for ensuring that the selected products are suitable for their applications. Buyers normally establish this by undertaking qualification programs on test stands, or by evaluating the performance of prototype machines or systems.

BUCHER HYDRAULICS

Germany

Tel.: +49 7742 8520
Fax: +49 7742 7116
info.de@bucherhydraulics.com

France

Tel.: +33 389 64 22 44
Fax: +33 389 65 28 78
info.fr@bucherhydraulics.com

Netherlands

Tel.: +31 7934 26 24 4
Fax: +31 7934 26 28 8
info.nl@bucherhydraulics.com

UK

Tel.: +44 2476 35 35 61
Fax: +44 2476 35 35 72
info.uk@bucherhydraulics.com

www.bucherhydraulics.com

USA

Tel.: +1 262 605 82 80
Fax: +1 262 605 82 78
info.wi@bucherhydraulics.com

Switzerland

Tel.: +41 33 672 61 11
Fax: +41 33 672 61 03
info.ch@bucherhydraulics.com

Italy

Tel.: +39 0522 92 84 11
Fax: +39 0522 51 32 11
info.it@bucherhydraulics.com

Austria

Tel.: +43 6216 44 97
Fax: +43 6216 44 97 4
info.at@bucherhydraulics.com

China

Tel.: +86 10 68 31 41 08
Fax: +86 10 68 31 41 21
info.bi@bucherhydraulics.com

Product Center, Elevator Hydraulics

Tel.: +41 41 757 03 33
Fax: +41 41 757 05 00
Info.nh@bucherhydraulics.com

We reserve the right of modification without prior notice.